

THE NEWBURY DISTRICT COUNCIL

(Land adjoining The Old Sawmills, Folly Road, Lickpen)

ARTICLE 4 DIRECTION 1992

Town and Country Planning General Development Order 1988

WHEREAS the Council of the District of Newbury being the appropriate local Planning Authority within the meaning of Article 4 of the Town and Country Planning General Development Order 1988 is satisfied that it is expedient that development of the description set out in the Schedule hereto should not be carried out on the land shown edged black on the plan annexed hereto unless permission therefor is granted on an application made under the Town and Country Planning General Development Order 1988

AND WHEREAS the Council are further of the opinion that development of the said description would constitute a threat to the amenities of their area and that the provisions of Paragraph 4 of Article 3 of the said Order should apply to this Direction.

NOW THEREFORE the said Council in pursuance of the powers conferred upon it by the said Article 4 hereby directs that the permission granted by Article 3 of the said Order shall not apply to development on the said land of the description set out in the Schedule hereto

THIS DIRECTION is made in pursuance of the provisions of Paragraph 4 of Article 3 and shall remain in force until 6th day of August 1992 (being six months from the date of this Direction) and will then expire unless it has been approved by the Secretary of State for the Environment before that date

SCHEDULE

The erection, construction, maintenance, improvement or alteration of a gate, fence, wall or other means of enclosure being development comprised within Part 2 of Class A of Schedule 2 of the Town and Country Planning General Development Order 1988 and not being development comprised within any other class

GIVEN under the Common Seal of the Newbury District Council this 6th day of February One thousand nine hundred and ninety-two.

THE COMMON SEAL of NEWBURY

DISTRICT COUNCIL is hereunto

affixed and authenticated by:

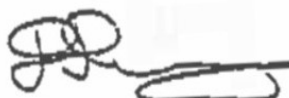

Authorised Signatory



NEWBURY D.C.

These records are to allow construction of the originals, retaining in their place permanent filmed images to save space. This certifies that these are preserved by microfilming exactly as in the original and that the original will be destroyed after inspection to ensure completeness and accuracy of the filmed images. ADVANCE MICRO-IMAGING LTD. *P. J. Harris*

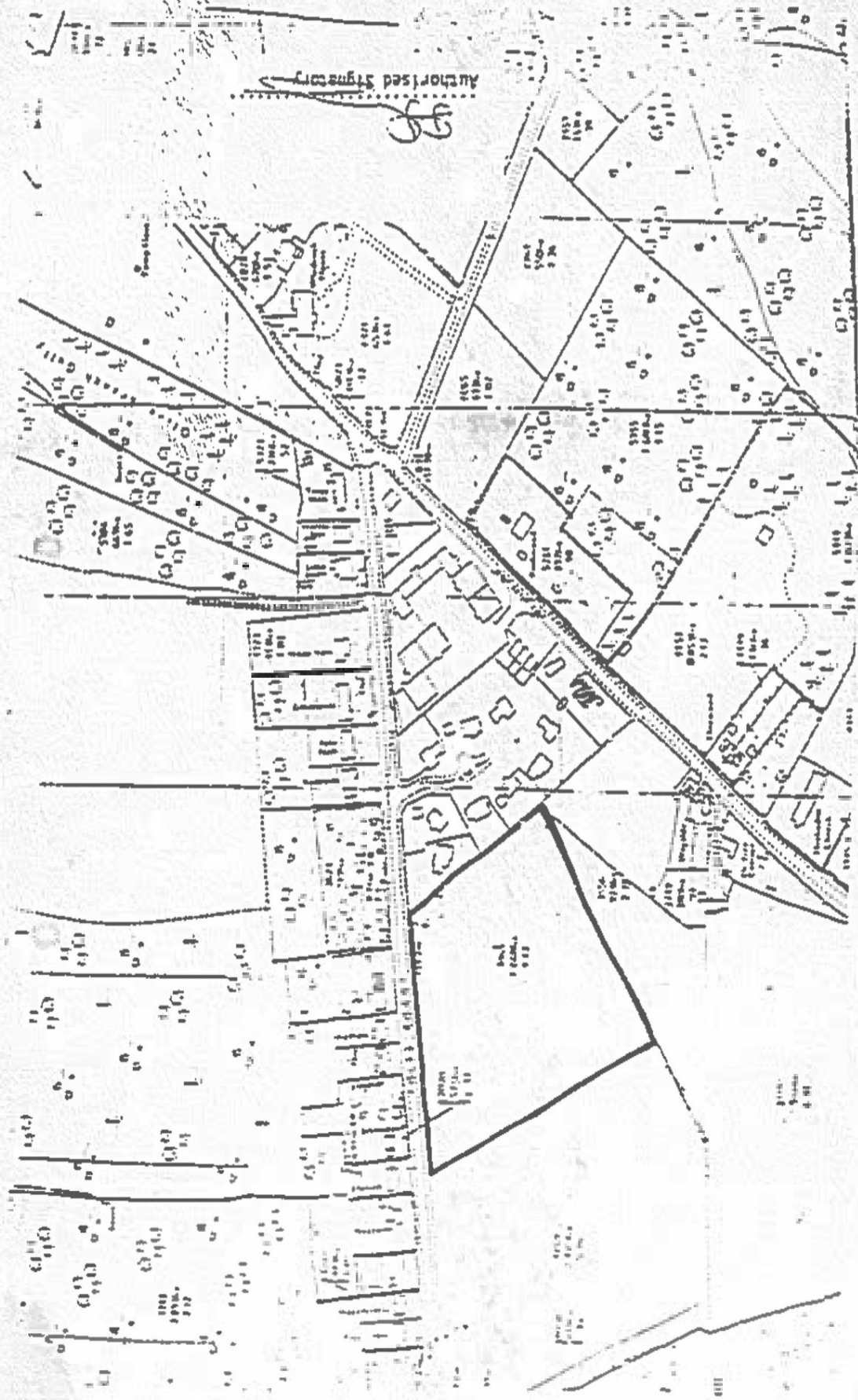

MERURY D.C.

These records are to allow destruction of the originals, retaining in their place permanent filmed images to save space. This certifies that these are preserved by microfilming exactly as in the original and that the original will be destroyed after inspection to ensure completeness and accuracy of the filmed images.

ADVANCE MICRO-IMAGING LTD. *R. Harris*