

**Sandleford Park, Newbury**

Appeal Reference: APP/W0340/W/20/3265460  
LPA Reference: 20/01238/OUTMAJ

**Transport Agreed Statement between West Berkshire  
Council and Vectos (on behalf of Bloor Homes and  
Sandleford Farm Partnership)**

**May 2021**

## **Figures**

**Figure 1 - Walking Routes**

## **Appendices**

- Appendix A - Monks Lane Eastern Access**
- Appendix B - Monks Lane Western Access**
- Appendix C - A339 College Access**
- Appendix D - Valley Crossing Design**
- Appendix E - Swan Roundabout Drawing 81311-041-108**
- Appendix F - A339/Pinchington Lane Drawing 172985\_A\_01 Rev C**
- Appendix G - St Johns Road Drawing 172985/A/12**

## FIGURES



- Key**
- Bloor Homes Application Site
  - Remainder of Strategic Allocation not within Bloor Application Site
  - Retail
  - Education
  - Leisure
  - Healthcare
  - Post Office
  - Newbury Railway Station
  - Route A
  - Route B
  - Route C
  - Route D
  - Route E
  - Route F

Bloor Homes Southern

Sandleford Park

Walking Routes Plan

SCALES:

NTS

DRAWN: SB	CHECKED: AW	DATE: 05/03/2021	REVISION: FINAL
--------------	----------------	---------------------	--------------------

**vectos.**

Network Building, 97 Tottenham Court Road, London W1T 4TP  
Tel: 020 7580 7373 Email: vectos@vectos.co.uk www.vectos.co.uk

DRAWING REFERENCE: Figure 1

## **APPENDIX A**

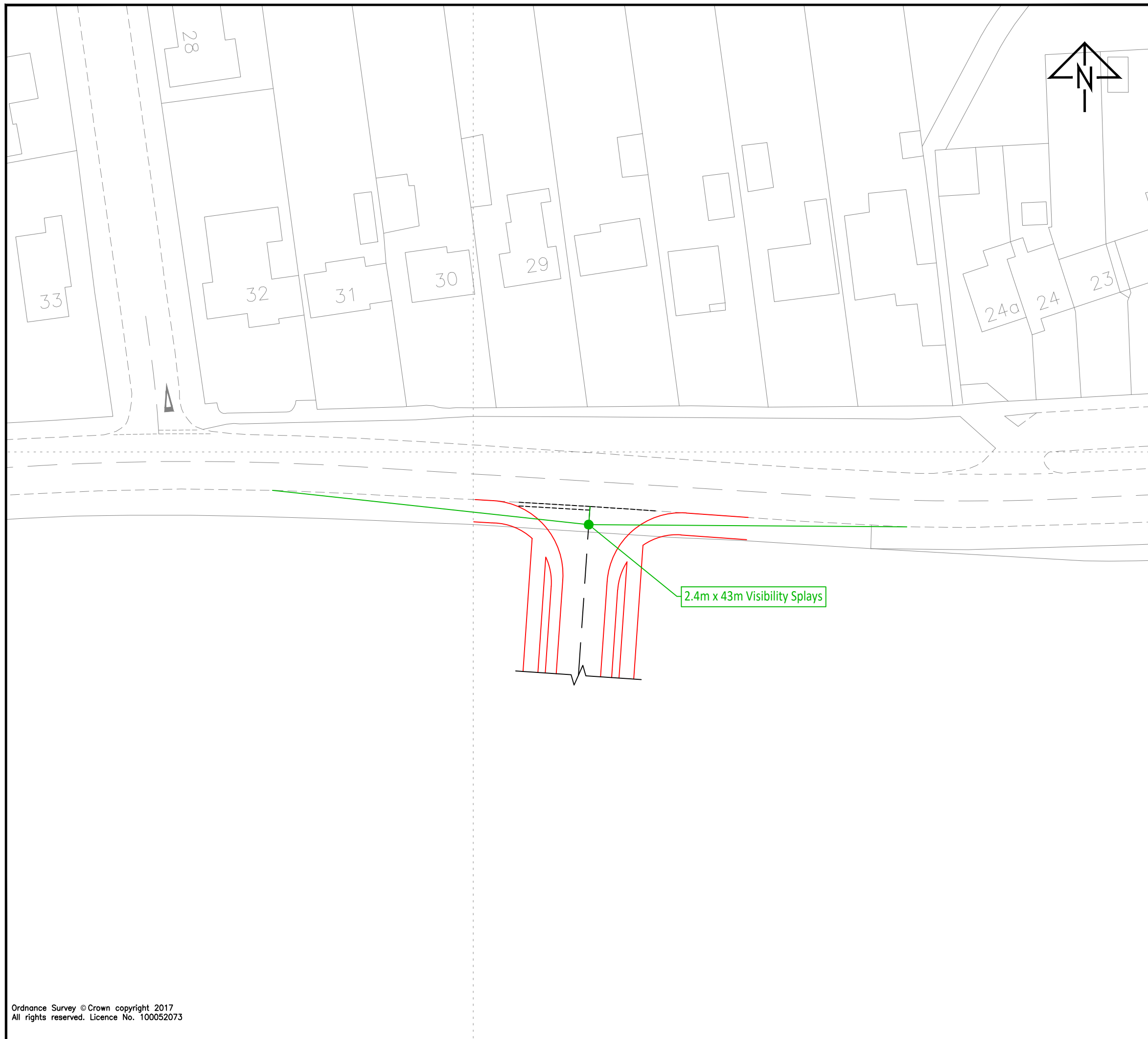

Notes:  
1. Drawing is subject to Section 278 Agreement

REV.	A	Visibility splays added	CJM	TF	23.09.2020
		DETAILS	DRAWN	CHECKED	DATE

CLIENT:  
**Bloor Homes**

PROJECT:  
**Sandleford Park  
Newbury**

DRAWING TITLE:  
**Eastern Site Access**

SCALES:  
**1:500 at A3**

DRAWN:	TF	CHECKED:	ES	DATE:	13.03.2018
--------	----	----------	----	-------	------------



Network Building, 97 Tottenham Court Road, London W1T 4TP  
t: 020 7580 7373 e: enquiries@vectos.co.uk

DRAWING NUMBER:	<b>172985/A/07.1</b>	REVISION:	<b>A</b>
-----------------	----------------------	-----------	----------

Ordnance Survey © Crown copyright 2017  
All rights reserved. Licence No. 100052073

NOTE: THE PROPERTY OF THIS DRAWING AND DESIGN IS VESTED IN VECTOS (SOUTH) LTD.  
IT MUST NOT BE COPIED OR REPRODUCED IN ANY WAY WITHOUT THEIR PRIOR WRITTEN CONSENT.

## **APPENDIX B**



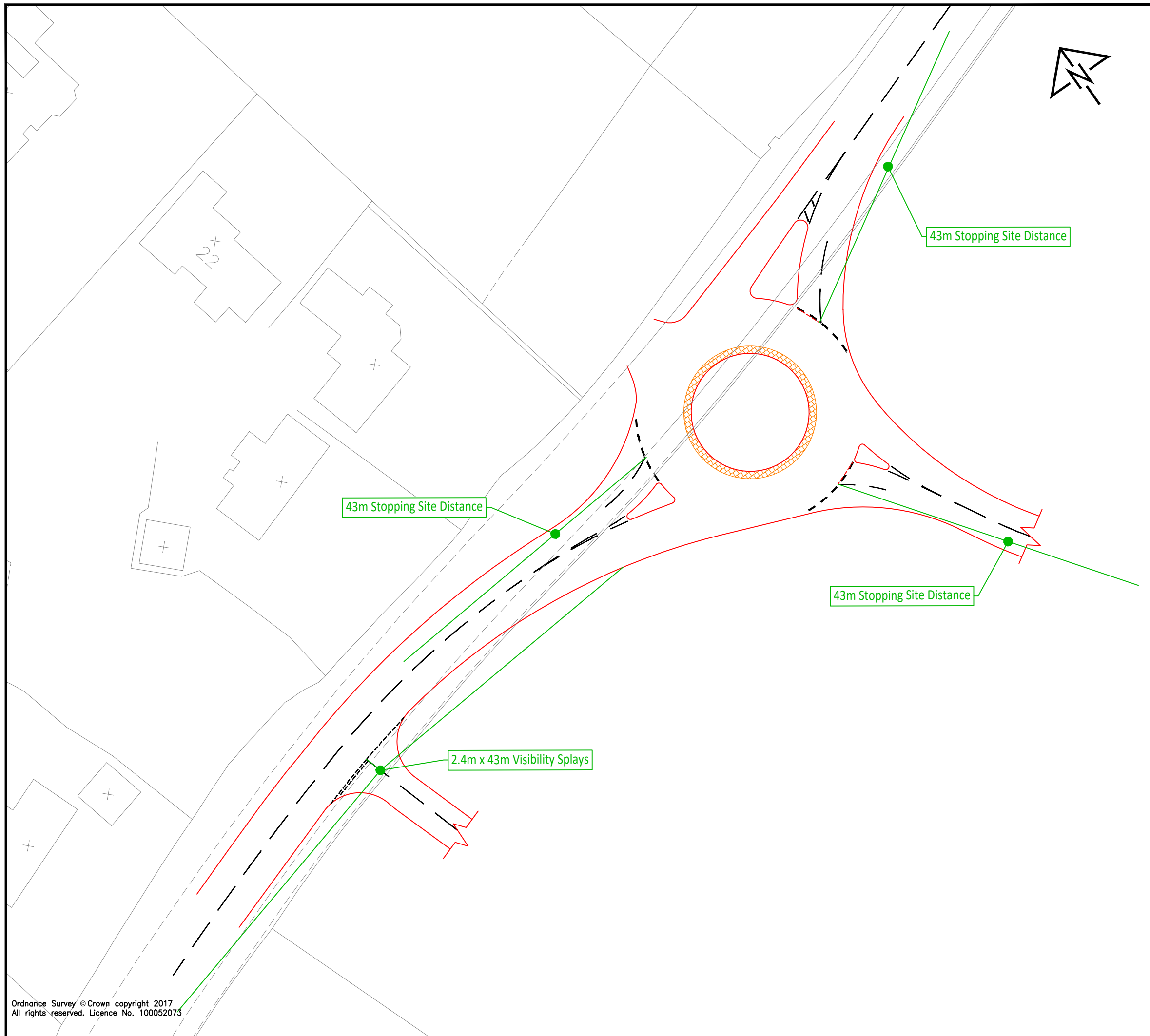

**Notes:**  
 1. Drawing is subject to Section 278 agreement

REV.	DETAILS	DRAWN	CHECKED	DATE
A	Visibility splays added	CJM	TF	23.09.2020

CLIENT:  
**Bloor Homes**

PROJECT:  
**Sandleford Park  
 Newbury**

DRAWING TITLE:  
**Western Junction Access**

SCALES:  
**1:500 at A3**

DRAWN: SC    CHECKED: AW    DATE: 19/03/2018



Network Building, 97 Tottenham Court Road, London W1T 4TP  
 t: 020 7580 7373    e: enquiries@vectos.co.uk

DRAWING NUMBER: **172985/A/08**    REVISION: **A**

Ordnance Survey © Crown copyright 2017  
 All rights reserved. Licence No. 100052073

NOTE: THE PROPERTY OF THIS DRAWING AND DESIGN IS VESTED IN VECTOS (SOUTH) LTD.  
 IT MUST NOT BE COPIED OR REPRODUCED IN ANY WAY WITHOUT THEIR PRIOR WRITTEN CONSENT.



## **APPENDIX C**



DO NOT SCALE

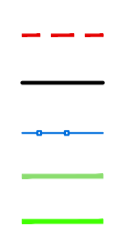
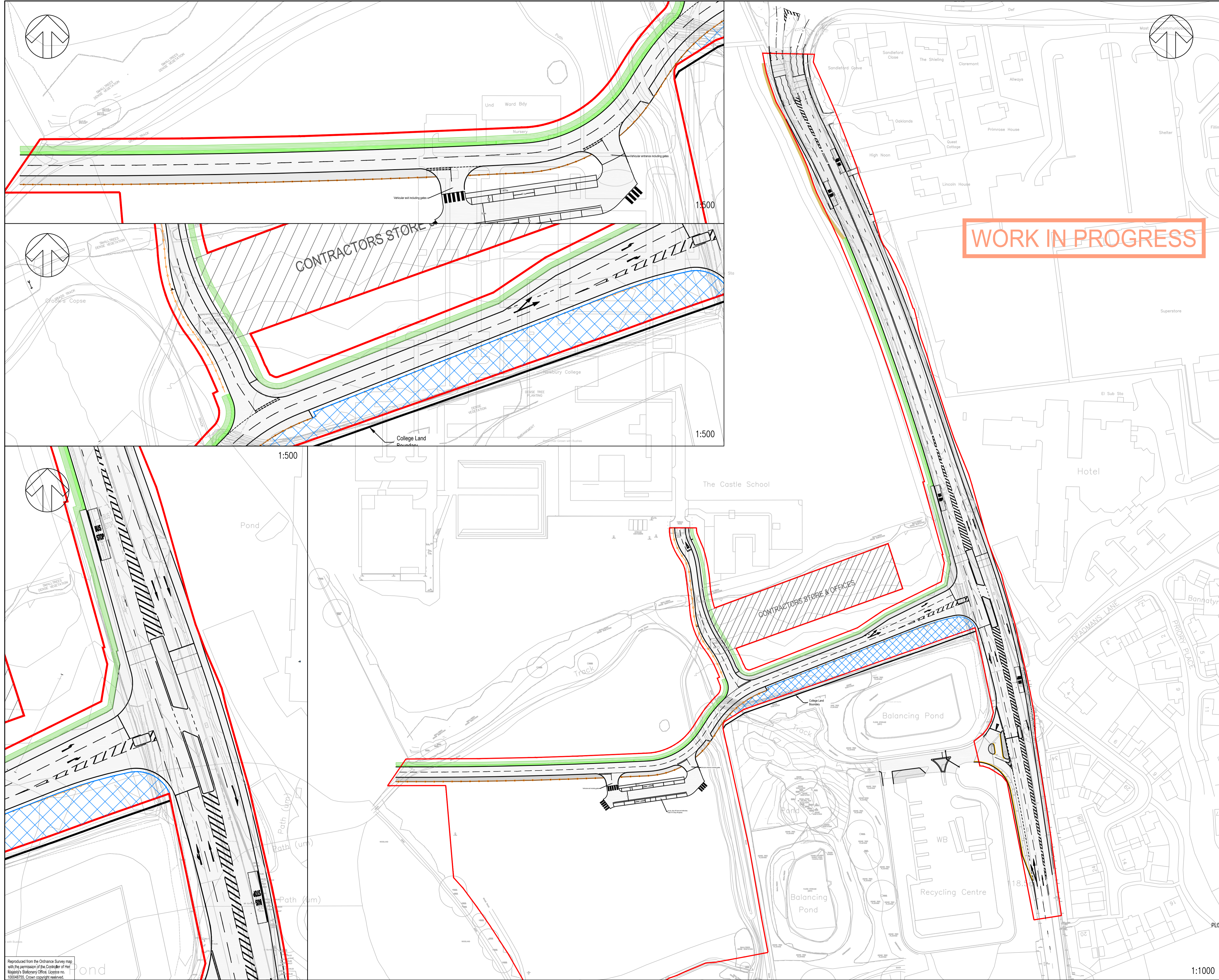

REV	DATE	BY	DESCRIPTION	CHK	APP
B	30/11/2017	AMS	DESIGN AMENDMENTS - CLIENT'S COMMENTS	FL	SB
A	16/11/2017	AMS	FIRST ISSUE	FL	SB

DRAWING STATUS: FOR INFORMATION ONLY

**wsp**  
 Regus House, Southampton International Business Park  
 George Curl Way, Southampton, Hampshire, SO18 2RZ  
 Tel: +44 (0)2380 302529 Fax: +44 (0)2380 302001  
 www.wsp.com

CLIENT: West Berkshire Council

ARCHITECT: -

PROJECT: A339 Sandleford, Newbury

TITLE: General Arrangement Plan

SCALE @ A1:	AS SHOW	CHECKED:	FL	APPROVED:	SB
CAD FILE:	PL011-27599-010 ROAD LAYOUT - REV C	DESIGN/DRAWN:	AMS	DATE:	September 2017

PROJECT No:	DRAWING No:	REV:
70034768	4768-SK-100	B

1:1000

© WSP Group Ltd

X:\PROJECTS\170000\172985 - SANDLEFORD PARK (INCOMING) WEST BERKSHIRE COUNCIL\2018-01-23 - A339-NEW COLLEGE ACCESS JUNCTION\PL011-27599-010 ROAD LAYOUT - REV C.DWG 24/01/2018 09:36:59 David Noyce

Reproduced from the Ordnance Survey map with the permission of the Controller of Her Majesty's Stationery Office. Licence no. 100048755. Crown copyright reserved.



## APPENDIX D

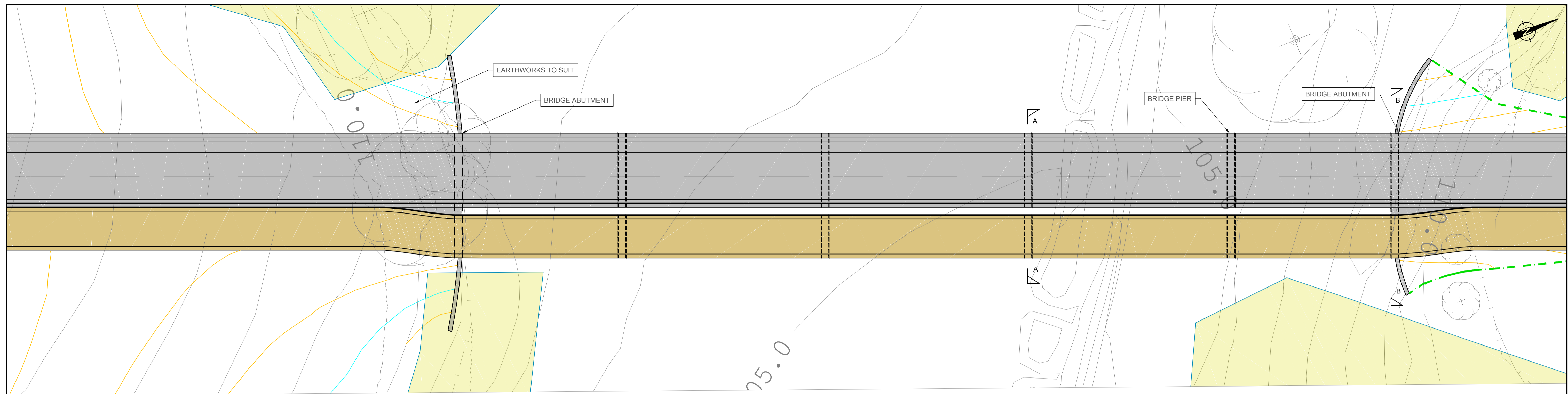

PLAN  
Scale 1:250

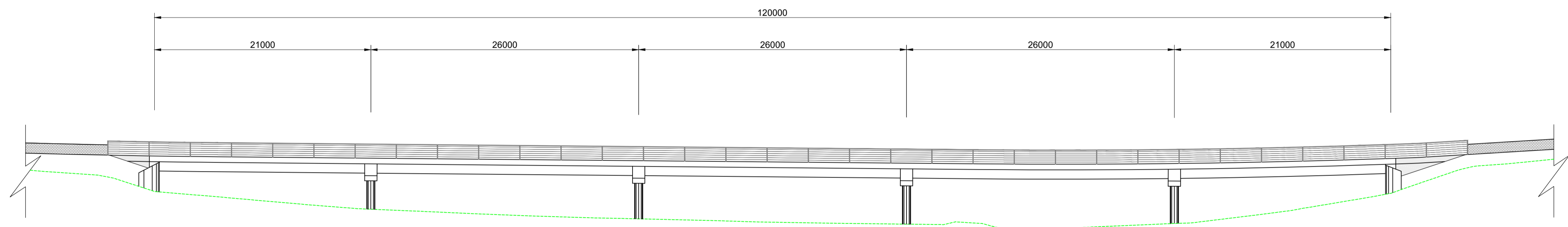

EAST ELEVATION  
scale 1:250

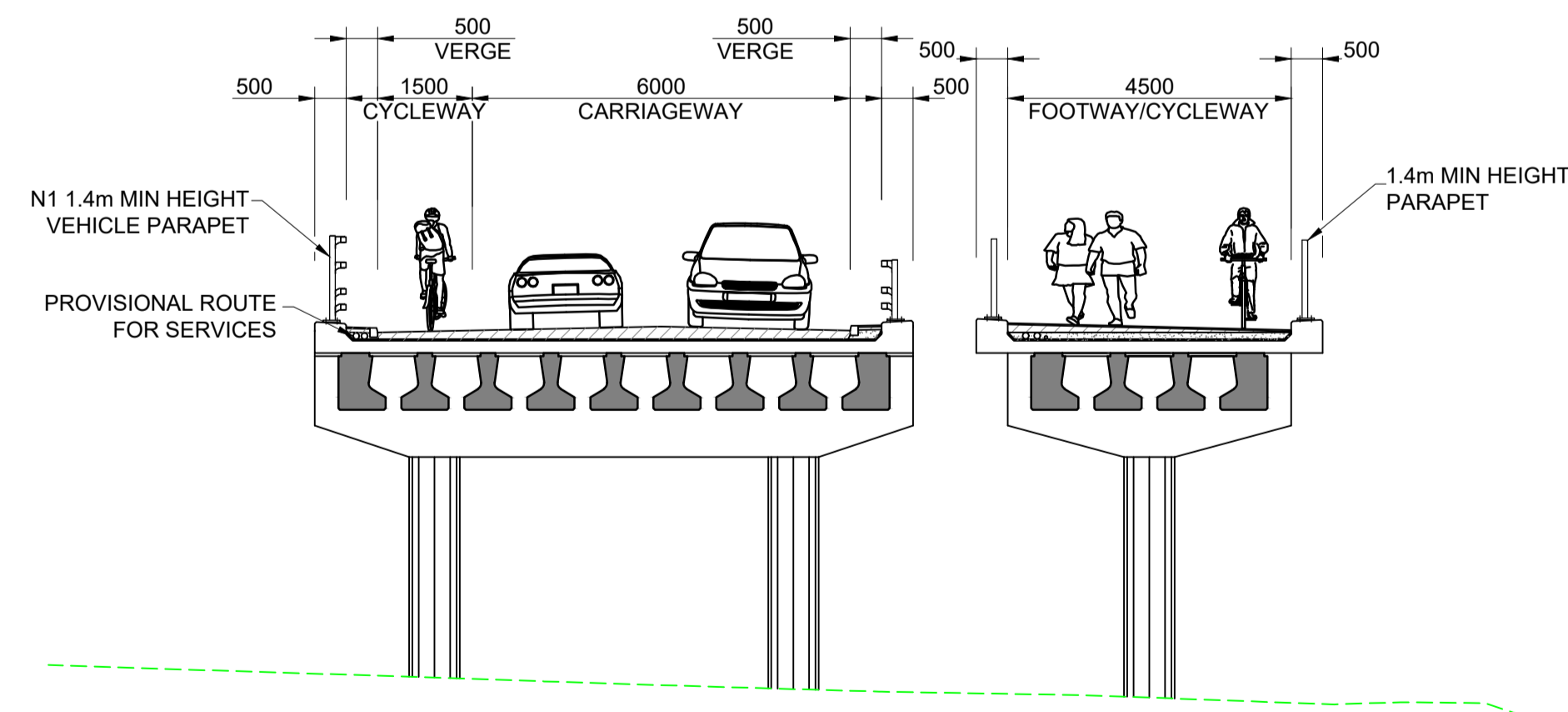

SECTION A-A  
scale 1:100

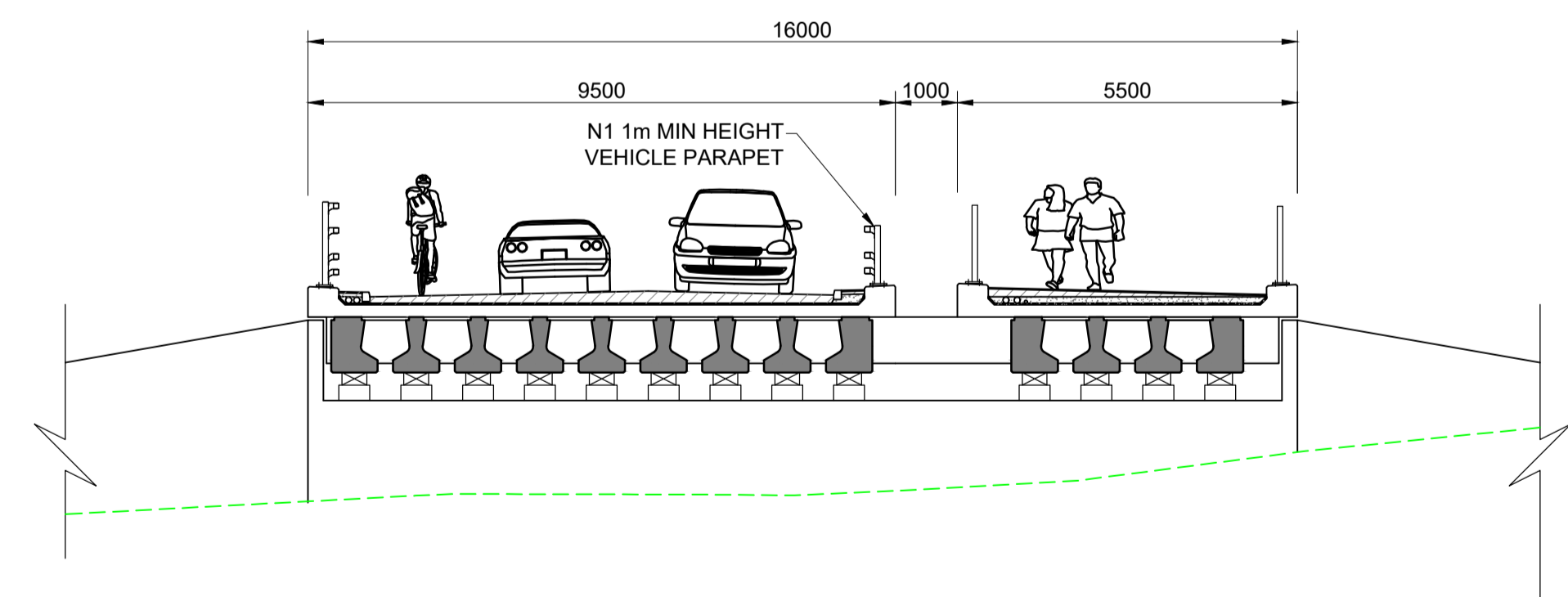

SECTION B-B  
scale 1:100

NOTE: THE PROPERTY OF THIS DRAWING AND DESIGN IS VESTED IN VECTOS (NORTH) LTD. IF MUST NOT BE COPIED OR REPRODUCED IN ANY WAY WITHOUT THEIR PRIOR WRITTEN CONSENT.

REV	DETAILS	DRAWN	CHECKED	APPROVED	DATE
1	FIRST ISSUE	CR	PFM	NS	12.03.21
2	CHANGES TO PARAPETS	CR	PFM	NS	16.03.21

NOTES:  
1. ALL DIMENSIONS IN MILLIMETERS UNLESS OTHERWISE STATED

KEY:  
--- EXISTING GROUND LEVEL  
--- EXTENTS OF EARTHWORKS

PROJECT:  
**SANDLEFORD PARK, NEWBURY**

CLIENT:  
**BLOOR HOMES**

DRAWING TITLE:  
**PROPOSED PARALLEL STRUCTURES  
STRAIGHT ALIGNMENT 5 SPAN OPTION**

DRAWN	CHECKED	APPROVED	DATE	SCALES
CR	PFM	NS	12/03/2021	AS SHOWN

DRAWING NUMBER: **VD17562-STR-SK-004** REVISION: **2**

## **APPENDIX E**



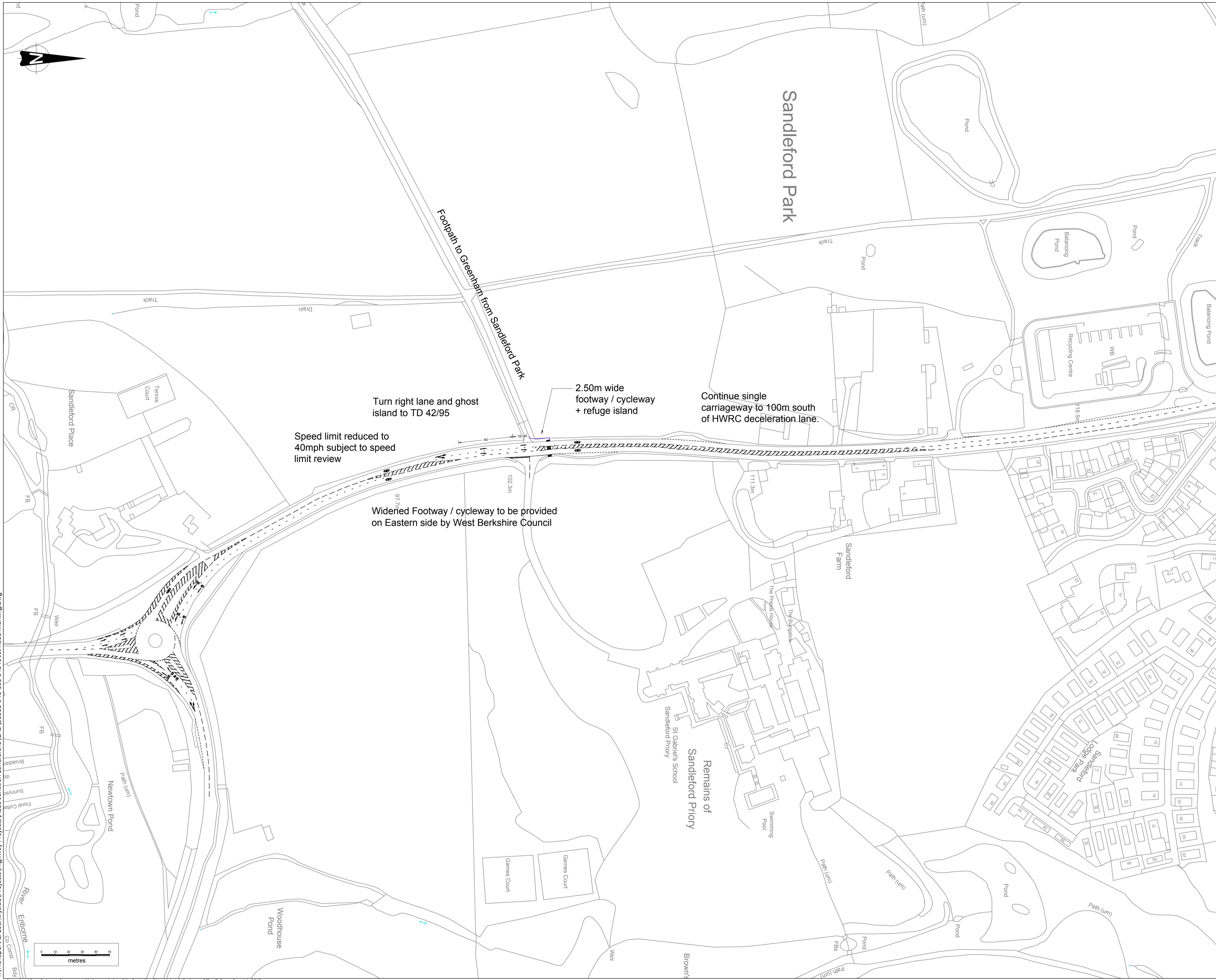

**KEY**  
 — Road Markings

- NOTES**
- 1) All dimensions are shown in metres unless shown otherwise.
  - 2) This drawing shows a proposed option and is subject to change following the location, depth and height of existing utility services.
  - 3) WBC Standard Details must be adhered to at all times unless specified by a WBC Engineer.
  - 4) Prior to any excavations the contractor will establish the location of existing utility services.

**DRAFT**

B				
A				
REV	DESCRIPTION	DR	AU	REV DATE
Status				



Transport & Countryside | Council Offices  
 Market Street | Newbury | RG14 5LD

Project Title				
<b>A339 Sandlerford</b>				
Drawing Title				
<b>A339/B4640 Junction Road Marking</b>				
Date	Drawn By	Checked By	Paper Size	Drawing Scale
18/04/2016	AT	NS	A1	1:1250
Drawing Number			Revision	
<b>81311-041-108</b>				

## APPENDIX F



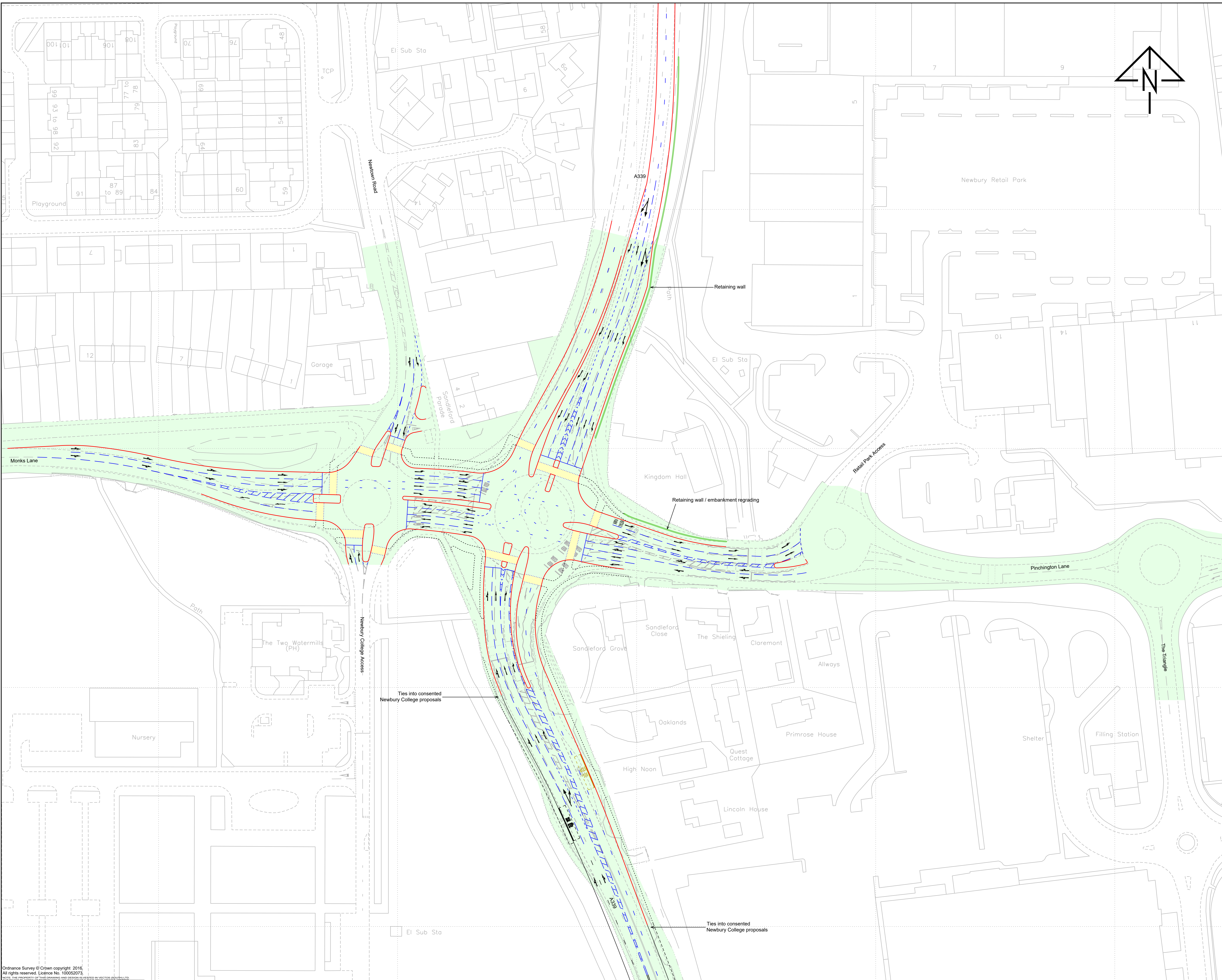

Notes:  
 1. This is not a construction drawing and is intended for illustrative purposes only.  
 2. White lining is indicative only.

REV	DETAILS	DRAWN	CHECKED	DATE
D	Out for approval	PP	AW	28.03.2021
C	Revisions following additional modelling	DSN	AW	14.03.2019
B	Revisions following comments from WBC	DSN	KOI	23.09.2018
A	Junctions revised following initial comments from WBC	DSN	KOI	13.12.2017

CLIENT: **Bloor Homes**

PROJECT: **SANDLEFORD PARK NEWBURY**

DRAWING TITLE: **A339 / Pinchington Lane / Monks Lane Junction Possible Signalisation Scheme**

SCALE: **1:500 at A0**

DRAWN	DSN	CHECKED	DATE	27.10.2017
-------	-----	---------	------	------------

**vectos.**  
 Network Building, 97 Tottenham Court Road, London W1T 4TP  
 t 020 7580 7373 e enquiries@vectors.co.uk

DRAWING NUMBER: **172985/A/01** REVISION: **D**

Ordnance Survey © Crown copyright 2016.  
 All rights reserved. Licence No. 100052073.  
 VECTOR is the property of VECTOR SIGNALISATION AND DESIGN LIMITED.



## **APPENDIX G**

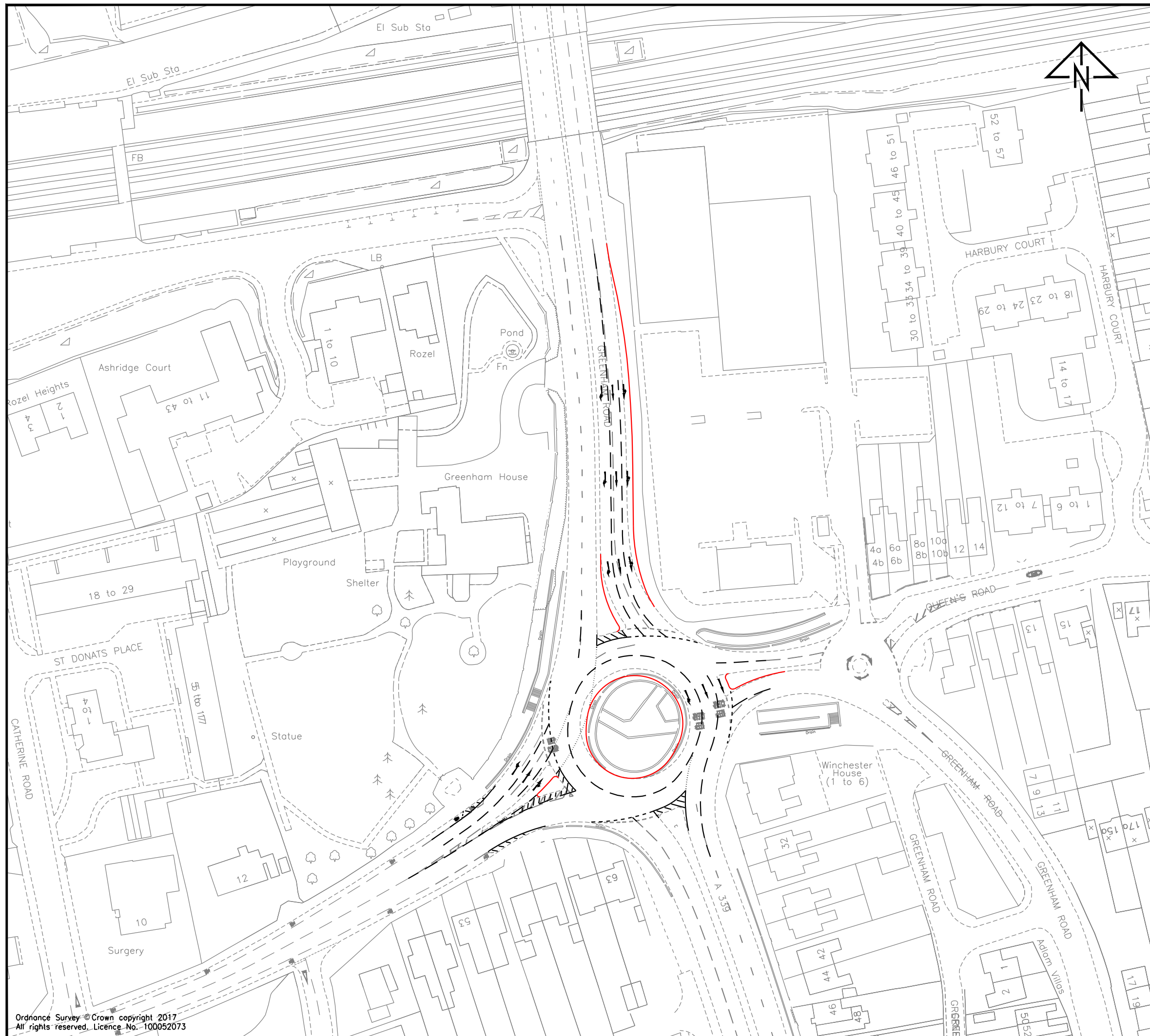

**Notes:**

1. This is not a construction drawing and is intended for illustrative purposes only.
2. White lining is indicative only.

REV.	DETAILS	DRAWN	CHECKED	DATE

CLIENT:  
**Bloor Homes**

PROJECT:  
**Sandleford Park  
Newbury**

DRAWING TITLE:  
**Proposed Capacity Improvements  
A339 / A343 Roundabout**

SCALES:  
**1:1000 at A3**

DRAWN: JM      CHECKED: AW      DATE: 21.06.2019



Network Building, 97 Tottenham Court Road, London W1T 4TP  
t: 020 7580 7373      e: enquiries@vectos.co.uk

DRAWING NUMBER: **172985/A/12**      REVISION: .

Ordnance Survey © Crown copyright 2017  
All rights reserved. Licence No. 100052073

NOTE: THE PROPERTY OF THIS DRAWING AND DESIGN IS VESTED IN VECTOS (SOUTH) LTD.  
IT MUST NOT BE COPIED OR REPRODUCED IN ANY WAY WITHOUT THEIR PRIOR WRITTEN CONSENT.